

# ADA SITE UPGRADES BUILDING 6 STEWART CAMPUS SWPD PROJECT NO. 21-S02-(4)

DESIGN DEVELOPMENT SUBMITTAL  
5500 Snyder Avenue, Carson City, Nevada  
APN: 00924119

DRAWING INDEX	CIVIL	DRAWING	DESCRIPTION
		PS.1	PROJECT SHEET, DRAWING INDEX, DESIGN TEAM, VICINITY MAP
		C0.1	GENERAL NOTES, ABBREVIATIONS & LEGEND
		C1.1	DEMOLITION PLAN
		C1.2	DEMOLITION PLAN
		C2.1	SITE-GRADING PLAN



DESIGN TEAM	<p><u>Client:</u> STATE OF NEVADA PUBLIC WORKS 515 E. Musser St. #102 Carson City, NV 89701 (775) 684-4148 Attn: Michael Rife</p> <p><u>Civil Engineer:</u> TECTONICS DESIGN GROUP 730 Sandhill Road, Suite 250 Reno, Nevada 89521 (775) 824-9988 Attn: Matt Rasmussen, P.E.</p>
-------------	--

PROJECT INFO	<p><u>BASIS OF BEARINGS</u> NAD 27 NEVADA STATE PLANE COORDINATE SYSTEM WEST ZONE MODIFIED BASED ON NDOT MONUMENTS 230108 L AND 230109 L COMBINED GRID TO GROUND FACTOR 1.000201040</p> <p><u>BASIS OF ELEVATION</u> THE BASIS OF ELEVATION IS NGVD 88</p>
--------------	--

DESIGN STANDARDS	<p><u>Current Code:</u> 2018 INTERNATIONAL BUILDING CODE 2010 ADA STANDARDS FOR ACCESSIBLE DESIGN SPWD ADOPTED STANDARDS</p>
------------------	--

COPYRIGHT:  
All drawings herein are the property of Tectonics Design Group and may not be reproduced or used in any capacity without the written authorization of Tectonics Design Group.

DRAWN: J.W.R.  
DESIGNED: J.W.R.  
CHECKED/STAMPED: MATT K. RASMUSSEN, P.E.

STAMP:  
10/24/23

PROFESSIONAL ENGINEER-STATE OF NEVADA  
MATTHEW K. RASMUSSEN  
Exp. 12-31-23  
CIVIL  
No. 16258

DESIGNER:  
TECTONICS  
DESIGN GROUP

730 Sandhill Rd., #250, Reno, Nevada 89521  
tel 775-824-9988  
fax 775-824-9986  
www.tectonicsdesigngroup.com

PROJECT/CLIENT:  
# : 23127

ADA Site Upgrades Building 6 Stewart Campus  
Building SPWD Project No. 21-S02-(4)  
5500 Snyder Avenue, Carson City, NV 89701  
State of Nevada Public Works  
515 E. Musser St #102, Carson City, Nevada 89701

SUBMITTAL RECORD:  
DATE: 10/24/23  
SUBMITTAL DESIGN DEVELOPMENT

SHEET TITLE:  
PROJECT INFORMATION  
DRAWING INDEX  
VICINITY MAP  
DESIGN TEAM

SHEET:  
PS.1



GENERAL NOTES

1. ALL CONSTRUCTION AND MATERIALS SHALL CONFORM TO THE BOOK "STANDARD SPECIFICATIONS FOR PUBLIC WORKS CONSTRUCTION" (2020 EDITION), AND THE "STANDARD DETAILS FOR PUBLIC WORKS CONSTRUCTION," INCLUDING ANY ADDITIONS OR MODIFICATIONS THAT ARE SET FORTH IN THE DRAWINGS OR SPECIFICATIONS.
2. THE CONTRACTOR SHALL ASSUME SOLE AND COMPLETE RESPONSIBILITY FOR JOB SITE CONDITIONS DURING THE COURSE OF CONSTRUCTION FOR THIS PROJECT, INCLUDING SAFETY OF ALL PERSONS AND PROPERTY; THAT THIS REQUIREMENT SHALL APPLY CONTINUOUSLY, AND NOT BE LIMITED TO NORMAL WORKING HOURS; AND THAT THE CONTRACTOR SHALL DEFEND, INDEMNIFY, AND HOLD THE OWNER AND ENGINEER HARMLESS FROM ANY AND ALL LIABILITY, REAL OR ALLEGED, IN CONNECTION WITH THE PERFORMANCE OF WORK ON THIS PROJECT, EXCEPTING FOR LIABILITY ARISING FROM THE SOLE NEGLIGENCE OF THE OWNER OR THE ENGINEER.
3. THE CONTRACTOR SHALL BE RESPONSIBLE FOR ALL EXCAVATION AND SHORING PROCEDURES AND CONFORM TO THE LATEST O.S.H.A. REQUIREMENTS.
4. THE CONTRACTOR SHALL MAINTAIN AN ON-GOING DUST CONTROL PROGRAM, INCLUDING WATERING OF OPEN AREAS, IN ORDER TO CONFORM WITH THE LATEST FEDERAL, STATE, AND COUNTY AIR POLLUTION REGULATIONS. THE CONTRACTOR SHALL SUBMIT FOR APPROVAL, A DUST CONTROL PLAN TO CARSON CITY DISTRICT HEALTH DEPARTMENT AIR POLLUTION CONTROL DIVISION PRIOR TO COMMENCEMENT OF ANY WORK.
5. THE CONTRACTOR SHALL BE RESPONSIBLE FOR DAILY REMOVAL OF ALL CONSTRUCTION MATERIALS LOST ON PAVED STREETS, ONSITE OR OFFSITE. AT THE CLOSE OF EACH DAY THE CONTRACTOR SHALL LEAVE THE SITE IN A CLEAN AND ORDERLY FASHION. ALL DEBRIS SHALL BE REMOVED FROM THE SITE OR PLACED IN A GARBAGE RECEPTACLE.
6. THE CONTRACTOR SHALL PURSUE THE WORK IN A CONTINUOUS AND DILIGENT MANNER, CONFORMING TO ALL THE PERTINENT SAFETY REGULATIONS, TO INSURE A TIMELY COMPLETION OF THE PROJECT.
7. THE CONTRACTOR SHALL NOTIFY THE DESIGN PROFESSIONAL, ALL GOVERNING AGENCIES HAVING JURISDICTION OVER THE WORK, UTILITY COMPANIES, TELEPHONE COMPANIES, CABLE TELEVISION COMPANIES, AND ANY OTHER ENTITY IMPACTED BY THE WORK 48 HOURS PRIOR TO BEGINNING CONSTRUCTION. THE CONTRACTOR SHALL GIVE 24 HOURS PRIOR NOTICE FOR ALL CONSTRUCTION STAKING AND INSPECTIONS REQUIRED DURING CONSTRUCTION.
8. ALL AREAS DISTURBED AND LEFT UNDEVELOPED FOR A PERIOD OF MORE THAN 30 DAYS SHALL BE STABILIZED BY THE APPLICATION OF AN APPROVED DUST PALLIATIVE AT NO EXPENSE TO THE OWNER.
9. THE CONTRACTOR SHALL OBTAIN AND PAY ALL FEES REQUIRED TO SECURE ANY AND ALL PERMITS NECESSARY TO PERFORM WORK WITHIN THE PUBLIC RIGHT-OF-WAY.
10. ALL UTILITY LOCATIONS, SIZES, AND DESCRIPTIONS AS SHOWN ARE FROM SURFACE OBSERVATIONS USED IN CONJUNCTION WITH REFERENCE MAPS, DRAWINGS, AND VERBAL STATEMENTS SUPPLIED BY UTILITY COMPANIES, AND MAY NOT BE WHOLLY ACCURATE OR RELIABLE. IT IS THE CONTRACTOR'S RESPONSIBILITY TO VERIFY ALL UTILITIES IN THE FIELD EITHER BY ACTUAL POTHOLING OR VISUALLY, AND NOTIFY THE ENGINEER OF ANY DISCREPANCIES. THE CONTRACTOR SHALL NOTIFY ALL UTILITY COMPANIES WHICH MAY BE AFFECTED BY THE WORK TO OBTAIN ASSISTANCE IN THE LOCATION OF EXISTING MAINS AND SERVICE CONNECTIONS. THE CONTRACTOR SHALL ALSO CALL U.S.A. (1-800-227-2600) PRIOR TO BEGINNING WORK.
11. THE CONTRACTOR SHALL BE RESPONSIBLE FOR ALL CONSTRUCTION SIGNING, BARRICADES AND TRAFFIC DELINEATION TO CONFORM TO THE STATE OF NEVADA, DEPARTMENT OF TRANSPORTATION, "NEVADA WORK ZONE TRAFFIC CONTROL MANUAL", AND THE MANUAL FOR UNIFORM TRAFFIC CONTROL DEVICES.
12. THE WORK IN THIS CONTRACT INCLUDES ALL ONSITE AND OFFSITE WORK SHOWN ON THESE DRAWINGS, DESCRIBED IN THE SPECIFICATIONS, OR REASONABLY IMPLIED.
13. SHOULD ANY PREHISTORIC OR HISTORIC REMAINS/ARTIFACTS BE DISCOVERED DURING CONSTRUCTION, WORK SHALL TEMPORARILY BE HALTED AT THE SPECIFIC SITE AND THE CONTRACTOR SHALL NOTIFY THE DEPARTMENT OF CONSERVATION AND NATURAL RESOURCES, DIVISION OF HISTORIC PRESERVATION AND ARCHAELOGY FOR THEIR INVESTIGATION OF THE DISCOVERY. THE PERIOD OF TEMPORARY DELAY SHALL BE LIMITED TO A MAXIMUM OF TWO WORKING DAYS FROM THE DATE OF NOTIFICATION.
14. ALL DIMENSIONS AND DISTANCES ARE TO FRONT FACE OF CURB, CURB RETURN, FACE OF BUILDING, FACE OF WALL, FLOW LINE, PROPERTY LINE, CENTER OF STRIPING, CENTER LINE OF PIPE OR MANHOLE, OR END OF IMPROVEMENTS.
15. THE CONTRACTOR SHALL PROTECT FROM DAMAGE EXISTING IMPROVEMENTS ON AND AROUND THE SITE INCLUDING, BUT NOT LIMITED TO, PAVEMENT, CURB & GUTTER, SIDEWALK, LANDSCAPING, SIGNAGE, STORM & SANITARY SEWERS, UTILITIES, TELEPHONE, AND CABLE TELEVISION. THE CONTRACTOR SHALL ASSUME SOLE RESPONSIBILITY FOR THE REPAIR AND/OR REPLACEMENT OF ANY IMPROVEMENTS (NEW OR EXISTING) DAMAGED THROUGHOUT THE COURSE OF CONSTRUCTION, EITHER AS A DIRECT RESULT OF HIS ACTIVITIES OR HIS FAILURE TO ADEQUATELY PROTECT THE IMPROVEMENT.
16. THE CONTRACTOR SHALL UPON COMPLETION OF THE PROJECT, PREPARE AND SUBMIT TO THE OWNER OR HIS REPRESENTATIVE, RECORD DRAWINGS INDICATING BY DIMENSION AND DESCRIPTION ANY FACILITY CONSTRUCTED CONTRARY TO THAT SHOWN ON THE DRAWINGS OR DESCRIBED IN THE SPECIFICATIONS.
17. PRIOR TO THEIR INCORPORATION INTO THE WORK, THE CONTRACTOR SHALL SUBMIT FOR THE ENGINEER'S APPROVAL, SHOP DRAWINGS AND MATERIAL SPECIFICATIONS FOR ALL MATERIALS TO BE USED ON THE PROJECT TO INCLUDE, BUT NOT BE LIMITED TO, ASPHALTIC CONCRETE AND PORTLAND CEMENT CONCRETE MIX DESIGN, AGGREGATE BASE QUALIFICATIONS, PIPE BEDDING, SELECT BACKFILL, PRECAST CONCRETE, CAST IRON GRATES AND COVERS, PIPING, FENCING, AND SIGNS.
18. THE CONTRACTOR SHALL AT ALL TIMES, PROVIDE AND MAINTAIN EMERGENCY ACCESS TO THE PROJECT SITE IN ACCORDANCE WITH THE REQUIREMENTS OF THE FIRE PROTECTION AGENCY HAVING JURISDICTION OVER THE PROJECT SITE.
19. ALL QUANTITIES SHOWN ON THE DRAWINGS ARE APPROXIMATE AND USED ONLY FOR PERMIT AND BOND PURPOSES ONLY. THEY SHALL NOT BE USED IN ANY WAY FOR BIDDING OR CONSTRUCTION PURPOSES. IT SHALL BE THE CONTRACTOR'S RESPONSIBILITY TO MAKE HIS OWN QUANTITY ESTIMATES FOR BIDDING AND CONSTRUCTION PURPOSES.
20. INSPECTION REQUIREMENTS SHALL BE IN ACCORDANCE WITH THE STANDARD SPECIFICATIONS.
21. THE CONTRACTOR SHALL SUBMIT A SCHEDULE OF EVENTS TO THE ENGINEER AND UPDATE IT EVERY TWO WEEKS, OR SUSTAIN WORK UNTIL IT IS COMPLETED, WITH NO TIME DELAYS IN THE CONTRACT PERIOD. THE SCHEDULE IS FOR THE OWNER AND HIS COORDINATION OF THE OVERALL OPERATION OF THE CONSTRUCTION. THE CONTRACTOR SHALL IN NO WAY IMPEDE THE OVERALL PERFORMANCE OF THE OWNER'S OPERATIONS.
22. ALL TRAFFIC CONTROL AND BARRICADING WITHIN THE CARSON CITY RIGHT-OF-WAY SHALL CONFORM TO SECTION 100.33, 332.04 AND 332.05 OF THE STANDARD SPECIFICATIONS, PART VI OF THE MANUAL ON UNIFORM TRAFFIC CONTROL DEVICES, LATEST EDITION, AND THE UNR T2 CENTER, TEMPORARY TRAFFIC CONTROL GUIDELINES LATEST EDITION. A TRAFFIC CONTROL PLAN MUST BE SUBMITTED AND APPROVED BY THE CARSON CITY ENGINEERING DIVISION PRIOR TO ANY STREET CLOSURES.
23. THE CONTRACTOR SHALL CALL UNDERGROUND SERVICE ALERT "CALL BEFORE YOU DIG" (811) OR (1-800-227-2600) AT LEAST TWO (2) WORKING DAYS PRIOR TO START OF CONSTRUCTION AND COMPLY WITH THE REQUIREMENTS OF NRS AND NAC 455 THROUGHOUT THE COURSE OF THE WORK.
24. THE CONTRACTOR SHALL CALL THE CARSON CITY ENGINEERING DIVISION (887-2300) TWO (2) WORKING DAYS PRIOR TO THE START OF CONSTRUCTION. THE CONTRACTOR SHALL CALL ONE (1) WORKING DAY PRIOR TO REQUIRED INSPECTIONS AND TESTING. THE REQUIRED INSPECTIONS AND TESTING ARE LISTED ON THE INSPECTION RECORD ISSUED WITH EACH PERMIT. THE CONTRACTOR MUST HAVE THE PERMIT NUMBER AND THE DESCRIPTION LISTED ON THE INSPECTION RECORD TO SCHEDULE REQUIRED INSPECTIONS AND TESTING. FOR CITY CONTRACTED PROJECTS, THE CONTRACTOR SHALL SCHEDULE INSPECTIONS PER THE CONTRACT DOCUMENTS.
25. MODIFICATIONS TO THE APPROVED PLANS REQUIRES REVIEW AND APPROVAL BY THE CARSON CITY ENGINEERING DIVISION. WORK PERFORMED WITHOUT WRITTEN APPROVAL BY CARSON CITY ENGINEERING WILL REQUIRE REMOVAL AT THE CONTRACTORS EXPENSE.
26. THE APPROVED PLAN, PERMIT AND INSPECTION RECORD MUST BE ON THE JOB SITE AT ALL TIMES.
27. PLAN APPROVAL FOR SEWER AND WATER CONSTRUCTION SHALL EXPIRE ONE YEAR FROM DATE OF APPROVAL UNLESS CONSTRUCTION HAS BEEN INITIATED. (CCMC 12.06.180F, 12.01.140D)
28. THE CONTRACTOR WILL BE SOLELY AND COMPLETELY RESPONSIBLE FOR ACQUIRING A STORMWATER DISCHARGE PERMIT FROM THE NEVADA DIVISION OF ENVIRONMENTAL PROTECTION INCLUDING DEVELOPING, SUBMITTING AND IMPLEMENTING A STORM WATER POLLUTION PREVENTION PLAN (SWPPP). THE CONTRACTOR SHALL DEVELOP, PLACE AND MAINTAIN STORM WATER PROTECTION DEVICES IN COMPLIANCE WITH THE NEVADA CONTRACTORS FIELD GUIDE FOR CONSTRUCTION SITE BEST MANAGEMENT PRACTICES (JUNE 2008).

DEMOLITION NOTES:

1. THE CONTRACTOR MAY SALVAGE ITEMS NOT SPECIFICALLY DESIGNATED AS NON-SALVAGEABLE WITH WRITTEN PERMISSION FROM THE ENGINEER. THE NON-SALVAGEABLE MATERIALS SHALL BE DISPOSED OF AT THE APPROPRIATE LOCATIONS.
2. THE CONTRACTOR SHALL BE RESPONSIBLE FOR THE PROPER OFF-SITE DISPOSAL OF MATERIALS TO BE REMOVED AND DISPOSED OF. THE CONTRACTOR SHALL COORDINATE WITH THE ENGINEER, AREAS TO BE USED FOR THE TEMPORARY STOCKPILING OF MATERIALS TO BE REMOVED.
3. THE CONTRACTOR SHALL WET-DOWN AND TARP EVERY TRUCK LOADS LEAVING THE SITE FOR A DISPOSAL AREA. THIS PROCEDURE IS CRITICAL TO THE DUST ABATEMENT PLAN AND WILL BE STRICTLY ENFORCED.
4. THE CONTRACTOR SHALL APPLY AND PAY FOR ALL PERMITS REQUIRED FOR THIS PROJECT, UNLESS SPECIFIED OTHERWISE.
5. IF STRUCTURE REMOVAL CREATES SIGNIFICANT DEPRESSIONS, THE CONTRACTOR SHALL ROUND OFF THE SIDES TO 3:1 SLOPE, AND COMPACT TO 85% M.D.D.
6. ALL SAWCUT LINES SHALL BE NEATLY DONE, PARALLEL AND PERPENDICULAR TO EXISTING IMPROVEMENTS. SAWCUT LINES SHALL BE ADJUSTED TO REASONABLY INCORPORATE AREAS OF DAMAGED CURB, GUTTER, SIDEWALK, AND PAVEMENT.
7. REMOVE AND DISPOSE OF ANY DEBRIS THAT IS WITHIN THE CONSTRUCTION LIMITS AND IS NOT SPECIFICALLY CALLED OUT.

SITE NOTES:

1. REFERENCE LANDSCAPING PLANS FOR MOUNDING, PLANTING, AND IRRIGATION CONSTRUCTION.
2. ALL P.C.C. CURB, GUTTER, SIDEWALK, AND SLOPE PAVING SHALL BE CLASS AA OR DA CONCRETE (4000 PSI), WITH BROOM FINISH, UNLESS OTHERWISE INDICATED.
3. CONCRETE SIDEWALKS SHALL HAVE 1/2" EXPANSION JOINTS AT ALL POINTS ABUTTING BUILDINGS AND STRUCTURES, EVERY 30 FOOT INTERVAL, AT ALL SIDEWALK RETURNS, AND OPPOSITE EXPANSION JOINTS IN ADJACENT CURB. EXPANSION JOINTS ABUTTING BUILDINGS AND STRUCTURES SHALL HAVE SILICONE APPLIED TO THE JOINT TO PREVENT WATER INTRUSION. WEAKENED PLANE JOINTS SHALL BE LOCATED AT INTERVALS NOT EXCEEDING 1-2 TIMES THE WIDTH AND NO MORE FREQUENTLY THAN 0.8 TIMES THE WIDTH. IN NO CASE SHALL REGULAR INTERVALS OF WEAKENED PLANE JOINTS IN EITHER DIRECTION EXCEED 10 FEET.
4. IN ALL AREAS WHERE NEW A.C. PAVEMENT OR PATCH IS TO MATCH EXISTING PAVEMENT, THE CONTRACTOR SHALL SAWCUT AND REMOVE THE EXISTING PAVEMENT 24" FROM SUCH IMPROVEMENTS OR AS INDICATED ON THE PLANS. NEW PAVEMENT OR PAVEMENT PATCH SHALL CONFORM TO THE EXISTING PAVEMENT AT THIS POINT AND TRANSITION SMOOTHLY TO THE NEW IMPROVEMENTS.
5. THE CONTRACTOR SHALL MAINTAIN FIRE ACCESS TO ALL THE BUILDINGS TO THE SATISFACTION OF THE CITY'S FIRE DEPARTMENT.
6. ALL DIMENSIONS AND DISTANCES ARE TO FRONT FACE OF CURB, CURB RETURNS, FACE OF BUILDINGS, FACE OF WALL, FLOWLINE, PROPERTY LINE, CENTER OF STRIPING, CENTERLINE OF PIPE OR MANHOLES, CENTER OF FENCING, OR END OF IMPROVEMENTS.
7. ALL QUANTITIES SHOWN ON THESE DRAWINGS ARE APPROXIMATE AND SHOULD BE USED FOR PERMIT PURPOSES ONLY. THEY SHALL NOT BE USED IN ANY WAY FOR BIDDING PURPOSES OR CONSTRUCTION PURPOSES. IT SHALL BE THE CONTRACTOR'S RESPONSIBILITY TO MAKE HIS OWN QUANTITY ESTIMATES FOR BIDDING AND CONSTRUCTION PURPOSES

AC	ACRES	LT	LEFT
AC	ASPHALTIC CONCRETE	M	MIDDLE ORDINATE
ACP	ASBESTOS CONCRETE PIPE	MGD	MILLION GALLONS PER DAY
BC	BUILDING CORNER	MH	MANHOLE
BDY	BOUNDARY	MOVC	MID-ORDINATE VERTICAL CURVE
BVC	BEGIN VERTICAL CURVE	MW	MONITORING WELL
BSW	BACK OF SIDEWALK	NIC	NOT IN CONTRACT
BW	BOTTOM OF WALL	NTS	NOT TO SCALE
C	RUNOFF COEFFICIENT	OG	ORIGINAL GROUND
CE	CORNER CONCRETE	OH	OVERHEAD
C&G	CURB AND GUTTER	OS	OFFSET LINE
CB	CATCH BASIN	P	PAD ELEVATION
CFS	CUBIC FEET PER SECOND	PC	POINT OF CURVATURE
C/L	CENTERLINE	PI	POINT OF INTERSECTION
CH	CHORD	PIP	PLASTIC IRRIGATION PIPE
CI	CAST IRON	PIV	POST INDICATOR VALVE
CMP	CORRUGATED METAL PIPE	PL	PROPERTY LINE
CO	CLEANOUT	PT	POINT OF TANGENCY
CONC.	CONCRETE	PRC	POINT OF REVERSE CURVATURE
CONST	CONSTRUCT	PVC	POLYVINYL CHLORIDE PIPE
CP	CONCRETE PIPE	Q	DISCHARGE RATE
CPLG	COUPLING	R	RADIUS
CR	CURB RETURN	(R)	RADIAL
D	DELTA	REBAR	REINFORCING BARS
DCV	DETECTOR CHECK VALVE	RCB	REINFORCED CONCRETE BOX
DI	DROP INLET OR DUCTILE IRON	RCF	REINFORCED CONCRETE PIPE
DIA	DIAMETER	REF	REFERENCE
DET	DETAIL	RET	RETURN
E	ELECTRICAL	RIB	RAPID INFILTRATION BASIN
EX	EXISTING	RIM	RIM ELEVATION
EL	ELEVATION OR ELBOW	ROW	RIGHT OF WAY
EC	END CURVE	RT	RIGHT
EP	EDGE OF PAVEMENT	S	SLOPE
ES	EDGE OF SAWCUT LINE	SD	STORM DRAIN
EVC	END VERTICAL CURVE	SF	SQUARE FOOT
FES	FLARED END SECTION	SHT	SHEET
FF	FINISH FLOOR	SS	SANITARY SEWER
FFC	FRONT FACE OF CURB	STL	STEEL
FFW	FRONT FACE OF WALL	STA	STATION
FG	FINISH GRADE	S/W	SIDEWALK
FH	FIRE HYDRANT	T	TRANSFORMER
FLG	FLANGE	(T)	TELEPHONE
FL	FLOW LINE	TEE	PIPE CONNECTION
G	GAS	TB	TOP OF BANK
(EX)	GROUND	TBC	TOP BACK OF CURB
GB	GRADE BREAK	TC	TOP OF CURB
GM	GAS METER	TC	TIME OF CONCENTRATION
GPM	GALLONS PER MINUTE	TG	TOP OF GRATE
GV	GAS VALVE	TOE	TOE OF SLOPE
HOR	HORIZONTAL	TP	TOP OF PAVEMENT
HP	HIGH POINT	TV	TELEVISION
HS	HOUSE SERVICE	TW	TOP OF WALL
I	INTENSITY	TYP	TYPICAL
IE	INVERT ELEVATION	VC	VERTICAL CURVE
IRS	IRON PIPE SIZE	VERT	VERTICAL
IRR	IRRIGATION	VPI	VERTICAL POINT OF INTERSECTION
L	LENGTH	W	WATER
LF	LINEAL FEET	WM	WATER METER
LOG	LIP OF GUTTER	WV	WATER VALVE
LP	LOW POINT		

ABBREVIATIONS

	PROPOSED TYPE 1 CURB AND GUTTER		STREET SIGN
	EXISTING TYPE 1 CURB AND GUTTER		PIPE BOLLARD
	PROPOSED MEDIAN CURB		BARBED WIRE FENCE
	EXISTING MEDIAN CURB		CHAIN LINK FENCE
	EXISTING MAJOR CONTOUR		ASPHALT CONCRETE PAVEMENT
	PROPOSED MAJOR CONTOUR		CONCRETE
	EXISTING MINOR CONTOUR		AIR RELEASE VALVE ASSEMBLY
	PROPOSED MINOR CONTOUR		PROPOSED DRAINAGE SWALE
	GRADE BREAK		EXISTING DRAINAGE SWALE
	EXISTING		RECLAIMED WATER MAIN (DASHED IF EXISTING)
	SLOPE IN PERCENT		FIRE WATER MAIN (DASHED IF EXISTING)
	ELEVATION @ FINISH GRADE		WATER MAIN (DASHED IF EXISTING)
	ELEVATION @ TOP OF CURB		SANITARY SEWER LATERAL
	ELEVATION @ GRADE BREAK		GAS MAIN (DASHED IF EXISTING)
	ELEVATION @ FLOW LINE		SPCC ELEC CONDUIT
	CATCH POINT		THRUST BLOCK
	STORM DRAIN MANHOLE (DASHED IF EXISTING)		CLEANOUT (DASHED IF EXISTING)
	CATCH BASIN		FIRE HYDRANT
	PROPERTY LINE		WATER VALVE
	LIGHT STANDARD		STORM DRAIN MAIN (DASHED IF EXISTING)
	HEADWALL		SANITARY SEWER MAIN (DASHED IF EXISTING)
	FLARED END SECTION		SINGLE WATER SERVICE (METER & BACKFLOW PREVENTER)
	UTILITY POLE		SANITARY SEWER MANHOLE (DASHED IF EXISTING)
	ELBOW, TEE, CROSS		

LEGEND

COPYRIGHT:

ALL drawings herein are the property of Tectonics Design Group and may not be reproduced or used in any capacity without the written authorization of Tectonics Design Group.

DRAWN: J.W.R.  
DESIGNED: J.W.R.  
CHECKED/STAMPED: MATT K. RASMUSSEN, P.E.

PROFESSIONAL ENGINEER-STATE OF NEVADA  
MATTHEW K. RASMUSSEN  
Exp. 12-31-23  
CIVIL  
No. 16258

10/24/23

TECTONICS  
DESIGN GROUP

730 Sandhill Rd., #250, Reno, Nevada 89521  
tel 775-824-9888  
fax 775-824-9860  
www.tectonicsdesigngroup.com

ADA Site Upgrades Building 6 Stewart Campus  
Building SPWD Project No. 21-S02-(4)  
5500 Snyder Avenue, Carson City, NV 89701  
State of Nevada Public Works  
515 E. Musser St #102, Carson City, Nevada 89701

PROJECT/CLIENT:

#: 23127

SUBMITTAL RECORD:

DATE: 10/24/23  
SUBMITTAL DESIGN DEVELOPMENT

SHEET TITLE:GENERAL NOTES  
ABBREVIATIONS  
LEGEND

SHEET:C0.1



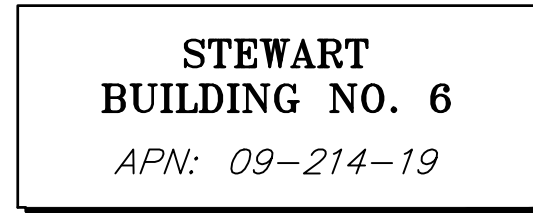

SCALE: 1" = 40'-0"



EX. SIDEWALK-

SCALE: 1" = 5'-0"

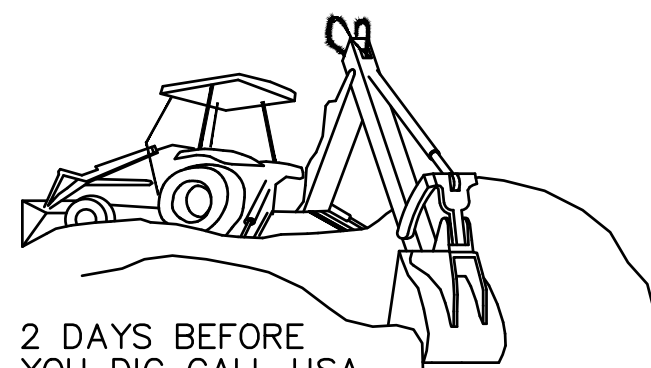

2 DAYS BEFORE  
YOU DIG CALL USA  
TOLL FREE 1-800-227-2600



EX. COLUMN TO  
BE PROTECTED  
IN PLACE

—EX. HANDRAIL TO BE REMOVED

EX. COLUMN TO  
BE PROTECTED  
IN PLACE

EX. CONCRETE PAD  
TO BE REMOVED

EX. STONE BASE TO  
REMAIN

EX. HANDRAIL  
BE REMOVED

SCALE: NTS



EX. SIDEWALK

SCALE: 1" = 5'-0"

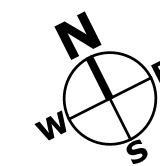

LEGEND:



— EXISTING FACILITIES TO BE REMOVED

 CONSTRUCTION NOTES:

1. SAWCUT

NOTES:

1. REFERENCE "GENERAL NOTES" ON SHEET C0.1
2. REFERENCE "ABBREVIATIONS" ON SHEET C0.1
3. REFERENCE "LEGEND" ON SHEET C0.1
4. ADD 4700 TO ALL FINISHED GRADE OR INVERT ELEVATIONS
5. CONTRACTOR TO FIELD VERIFY EXISTING CONDITIONS PRIOR TO FINALIZING BID.



EX. HANDRAIL TO  
BE REMOVED

EX. STONE BASE TO  
REMAIN

SCALE: NTS



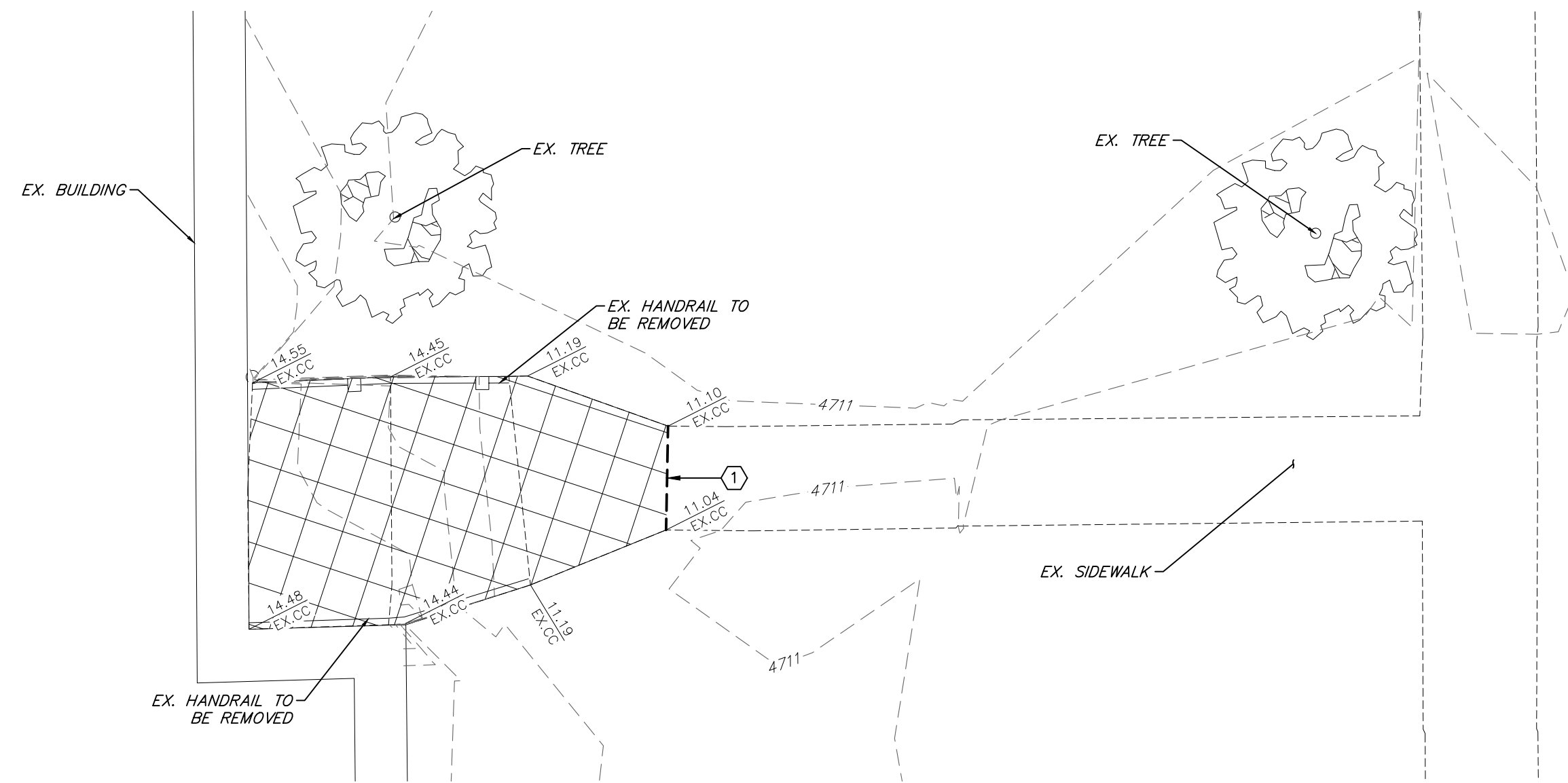
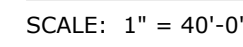

SCALE: 1" = 5'-0"



CONSTRUCTION NOTES:

1. SAWCUT

NOTES:

1. REFERENCE "GENERAL NOTES" ON SHEET C0.1
2. REFERENCE "ABBREVIATIONS" ON SHEET C0.1
3. REFERENCE "LEGEND" ON SHEET C0.1
4. ADD 4700 TO ALL FINISHED GRADE OR INVERT ELEVATIONS
5. CONTRACTOR TO FIELD VERIFY EXISTING CONDITIONS PRIOR TO FINALIZING BID.

LEGEND:



— EXISTING FACILITIES TO BE REMOVED

All drawings herein are the property of Tectonics Design Group and may not be reproduced or used in any capacity without the written authorization of Tectonics Design Group.

DRAWN: J.W.R.  
DESIGNED: J.W.R.  
CHECKED/STAMPED:  
MATT K. RASMUSSEN, P.E.

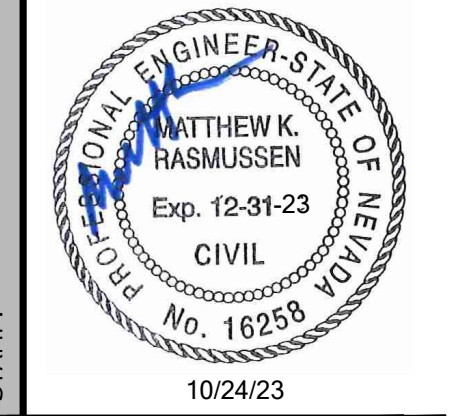

•

**TECTONICS  
DESIGN GROUP**

730 Sandhill Rd., #250, Reno, Nevada 89521  
tel 775-824-9988  
www.tectonicsdesigngroup.com  
fax 775-824-9986

11

ADA Site Upgrades Building 6 Stewart Campus  
Building SPWD Project No. 21-S02-(4)  
5500 Snyder Avenue, Carson City, NV 89701

# 23127

DATE:	SUBMITTAL
10/24/23	DESIGN DEVELOPMENT

1121

1003

## C1.2

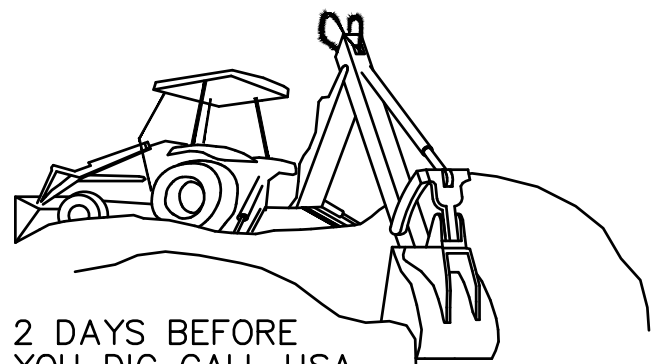

2 DAYS BEFORE  
YOU DIG CALL USA  
TOLL FREE 1-800-227-2600

STEWART  
BUILDING NO. 6  
APN: 09-214-19

LOCATION MAP

SCALE: 1" = 40'-0"

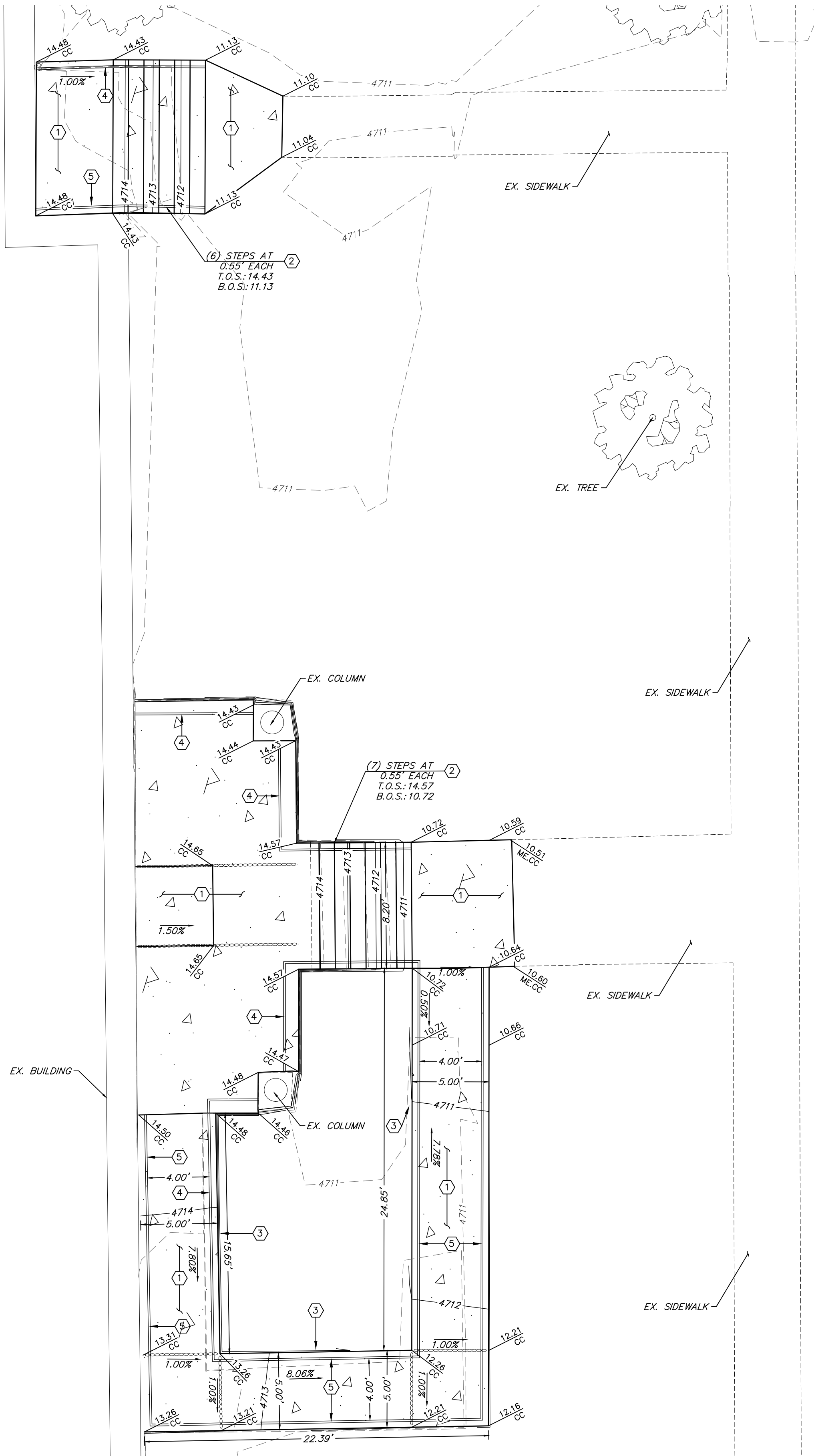
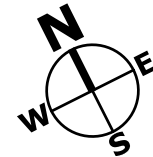

AREA 'A' SITE/GRADING PLAN

SCALE: 1" = 5'-0"



- NOTES:
1. ALL EXTERIOR CONCRETE EXPOSED TO FREEZING AND THAWING CONDITIONS SHOULD BE RATED AT 4,500 PSI MINIMUM
  2. REFERENCE "GENERAL NOTES" ON SHEET C0.1
  3. REFERENCE "ABBREVIATIONS" ON SHEET C0.1
  4. REFERENCE "LEGEND" ON SHEET C0.1
  5. ADD 4700 TO ALL FINISHED GRADE OF INVERT ELEVATIONS
  6. GENERAL CONTRACTOR TO FIELD VERIFY EXTENT OF ALL PROPOSED GUARDRAILS PRIOR TO FABRICATION.

- CONSTRUCTION NOTES:
1. CONSTRUCT TYPICAL SIDEWALK
  2. CONSTRUCT TYPICAL STAIR & HANDRAIL
  3. CONSTRUCT ADA RAMP
  4. CONSTRUCT GUARDRAIL
  5. CONSTRUCT HANDRAIL

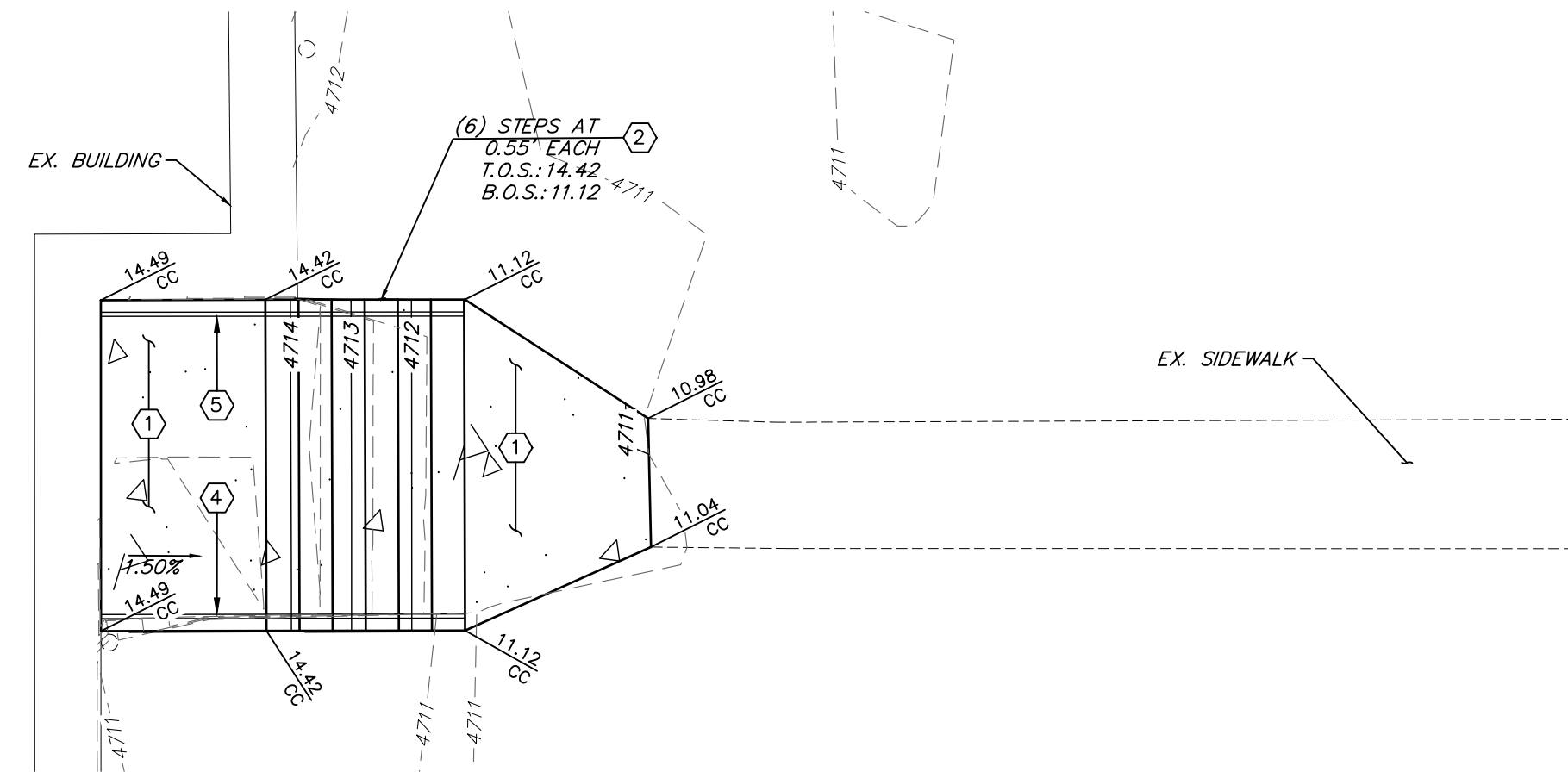

AREA 'B' SITE/GRADING PLAN

SCALE: 1" = 5'-0"



COPYRIGHT: All drawings herein are the property of Tectonics Design Group and may not be reproduced or used in any capacity without the written authorization of Tectonics Design Group.

DRAWN: J.W.R.  
DESIGNED: J.W.R.  
CHECKED/STAMPED: MATT K. RASMUSSEN, P.E.

PROFESSIONAL ENGINEER-STATE OF NEVADA  
MATTHEW K. RASMUSSEN  
Exp. 12-31-23  
CIVIL  
No. 16258  
10/24/23

TECTONICS  
DESIGN GROUP

730 Sandhill Rd., #250, Reno, Nevada 89521  
tel. 775-824-9988  
fax. 775-824-9986  
www.tectonicsdesigngroup.com

PROJECT/CLIENT: ADA Site Upgrades Building 6 Stewart Campus  
Building SPWD Project No. 21-S02-(4)  
5500 Snyder Avenue, Carson City, NV 89701  
State of Nevada Public Works  
515 E. Musser St #102, Carson City, Nevada 89701

# : 23127

DATE: 10/24/23  
SUBMITTAL DESIGN DEVELOPMENT

SUBMITTAL RECORD:

SHEET TITLE: SITE-GRADING PLAN

SHEET: C2.1